



the
**Henry
Ford**



Rouge Oxbow Restoration Project

The Rouge Oxbow Restoration project is a collaborative effort between Wayne County, the Henry Ford and the State of Michigan.

This project was funded by a Clean Michigan Initiative Waterfront Redevelopment Grant and the Rouge River National Wet Weather Demonstration Project.

Design/Construction Team: Environmental Consulting & Technology, Inc.; Tilton & Associates, Inc.; Applied Science, Inc.; Hansen Engineering; Angelo Iafrate Construction and Marine City Nursery



ox-bow (ˈɒks-boʊ) *n*: a meander of a river that has been cut off from the flow of water, typically contains shallow water wetlands

Rouge Oxbow Restoration Project

The main objective of the project is to restore valuable fish and wildlife habitat within the Rouge River and to restore functioning riverine wetlands that have been lost due to channelization of the river. Secondary objectives include improvement of water quality, increased floodplain storage, educational / interpretative opportunities and improved aesthetics.

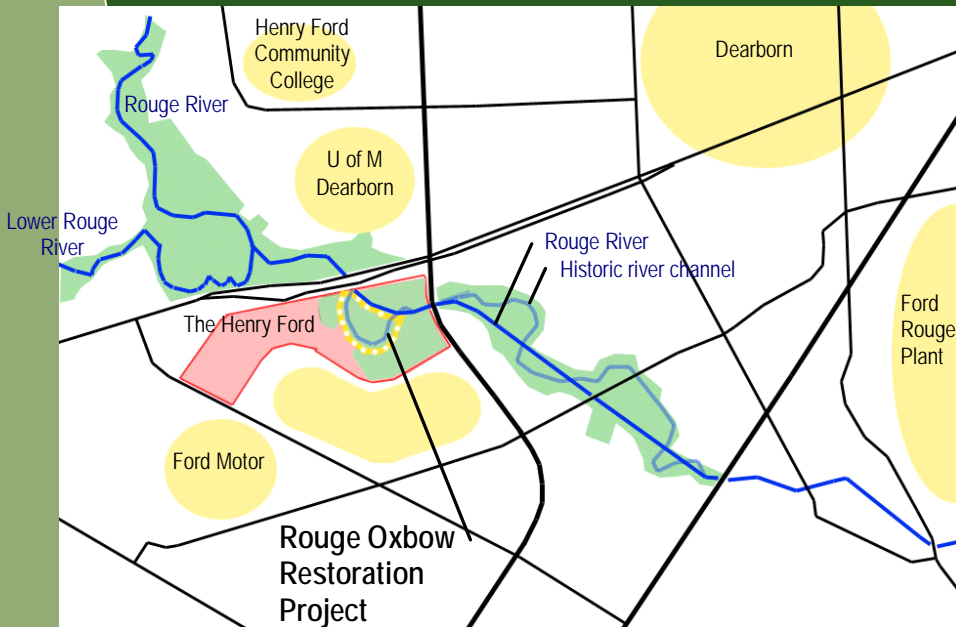

Rouge Oxbow Restoration Phases & Features

Phase 1 – Oxbow Wetland Restoration:

Project Design (Phase 1) –
March 2000 – Feb. 2001

Construction (Phase 1) –
Spring 2001 – July 2002

Trail / signage installation –
Fall 2003

Phase 2 – Combined
sewer overflow(CSO)
removal

Phase 3 – Open
water connection to
the Rouge River

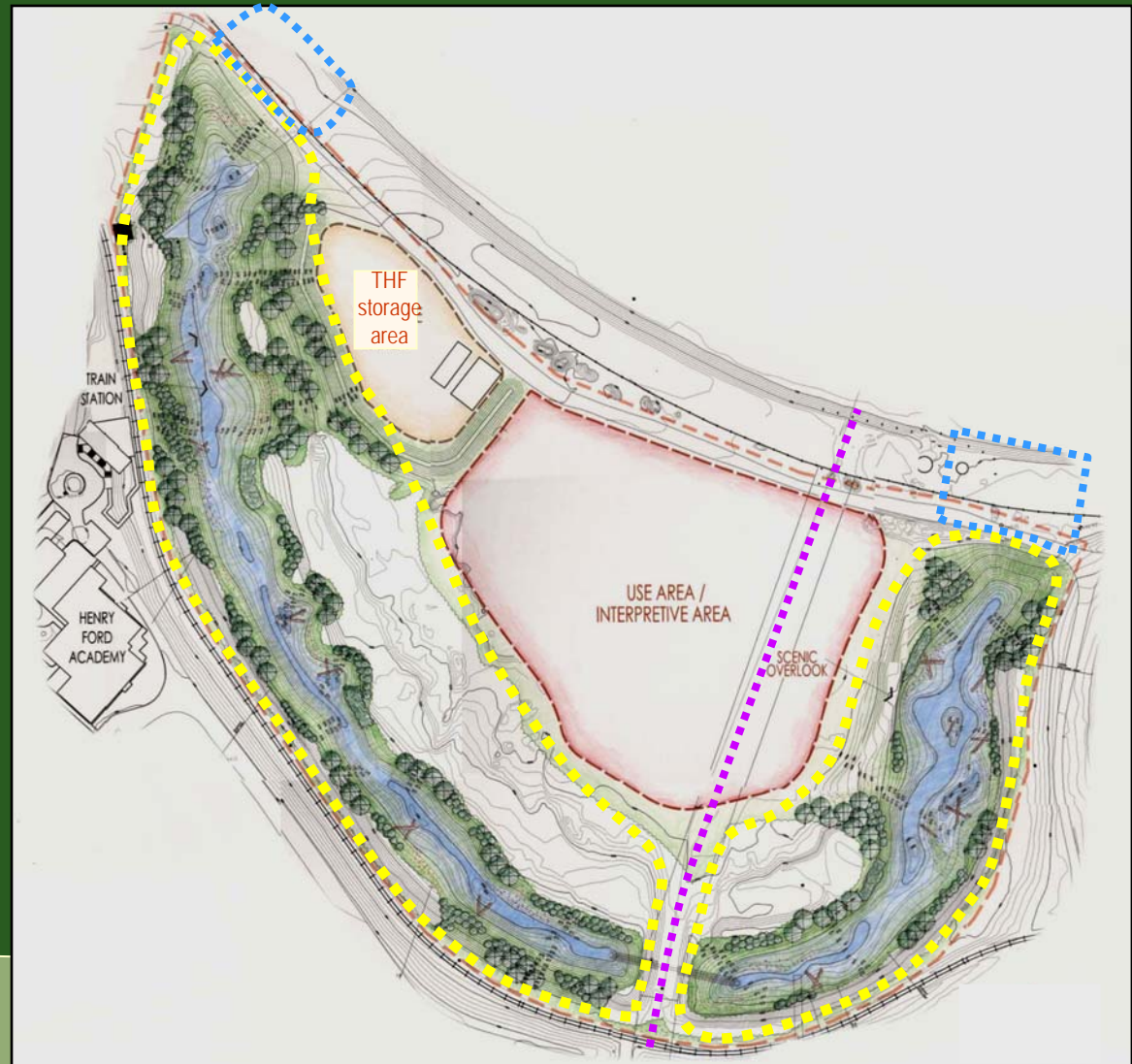

Rouge Oxbow Restoration Features

Phase 1 – Oxbow Wetland Restoration

- Restored fish and wildlife habitat
- Demonstration project for river and wetland restoration
- New interpretive and educational opportunities for river and ecology
- New trails
- Views from the train

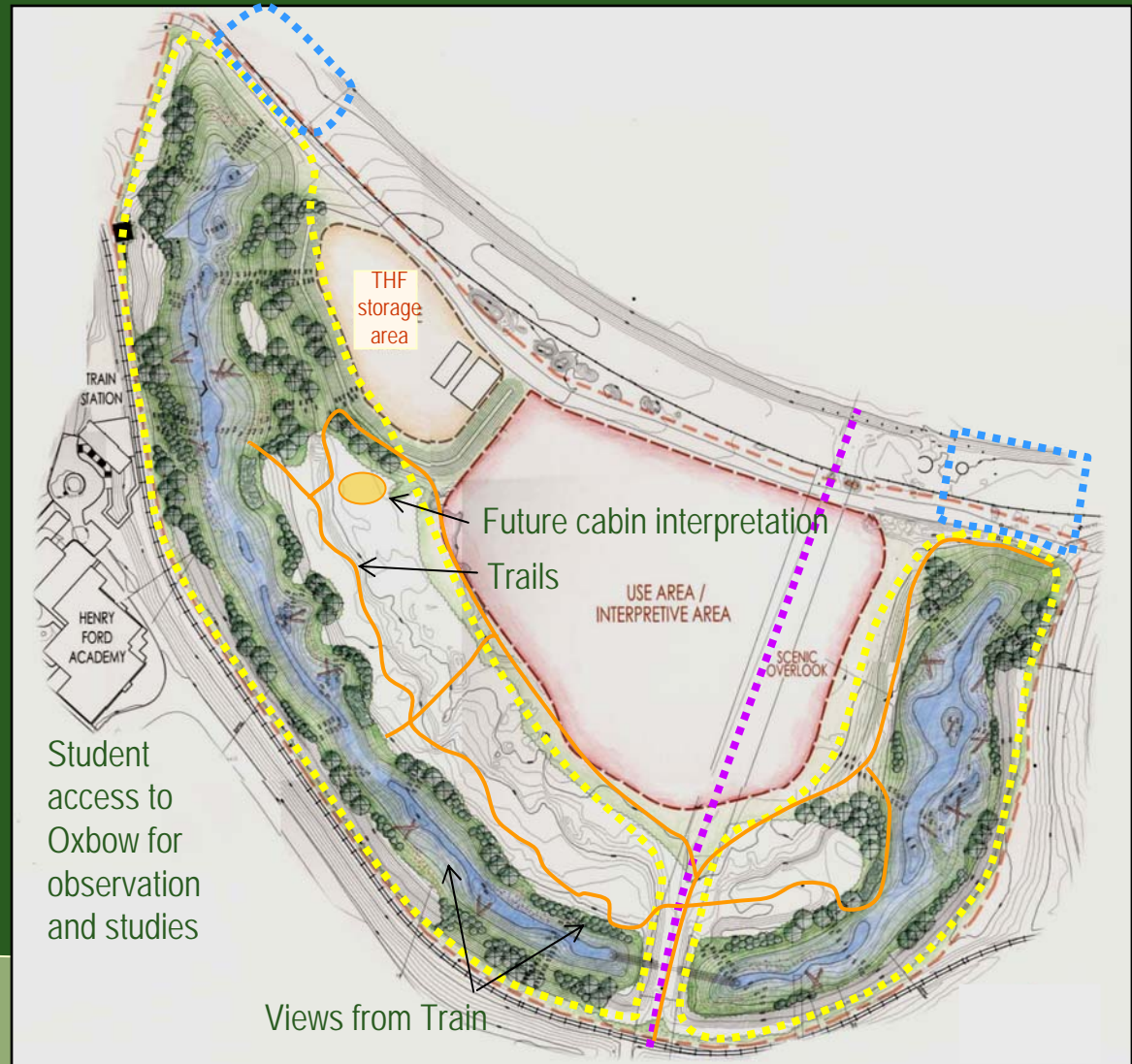

Design Considerations

- Hydrologic calculations for expanded floodplain
- Water quality improvements
- Trash and debris removal from existing channel
- Existing feature preservation (woodlands, railroad, CSO)
- Aquatic habitat design, wetland design
- Plant selection (native southeast Michigan, ethnobotanical value)
- Interpretive opportunities, programming
- Aesthetics



Construction Process – Phase 1

- Clearing and grubbing
- Excavation and trash removal
- Storm sewer excavation and removal, headwall construction
- Siphon construction under CSO
- Final grading and topsoil placement



GPS guided dozers provided final grade accuracy

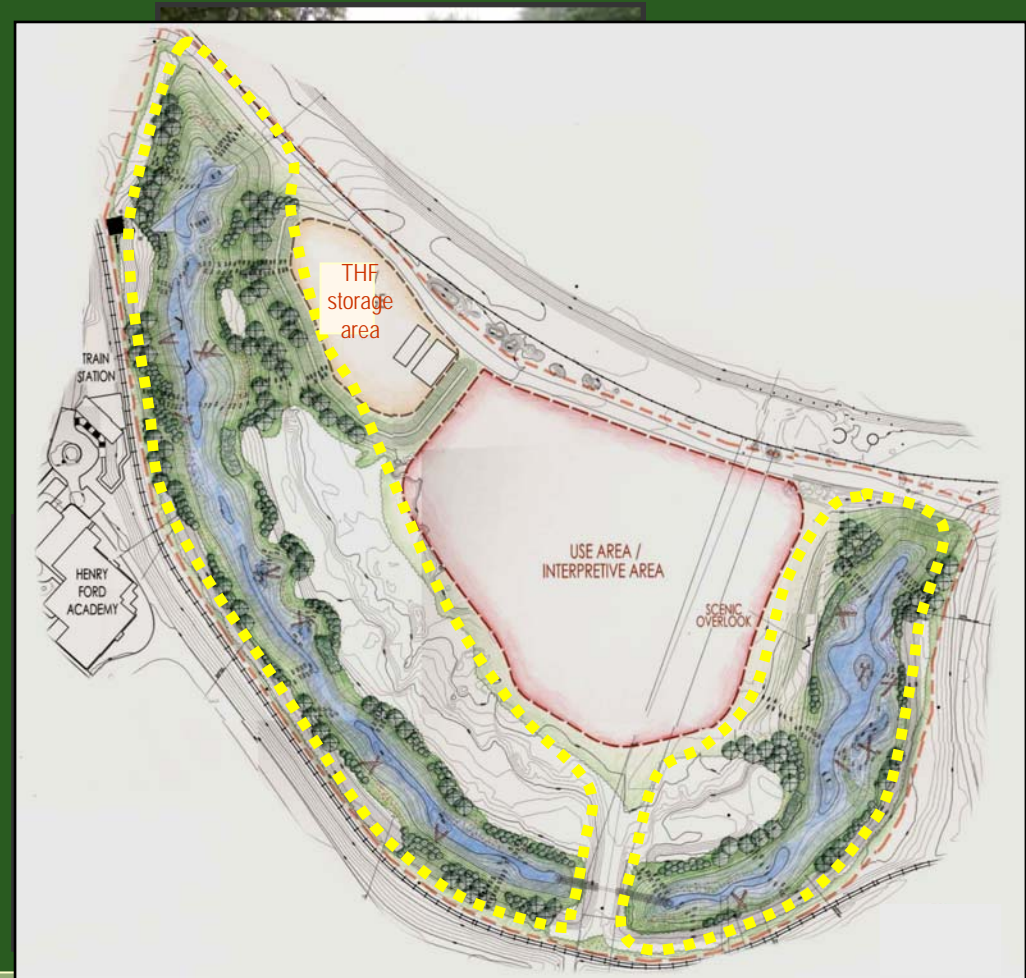

Construction Process – Phase 1

- Revegetation (seeding, trees, shrubs)
- Habitat placement
- Invasive species removal (buckthorn, honeysuckle, garlic mustard)
- Trails and signage

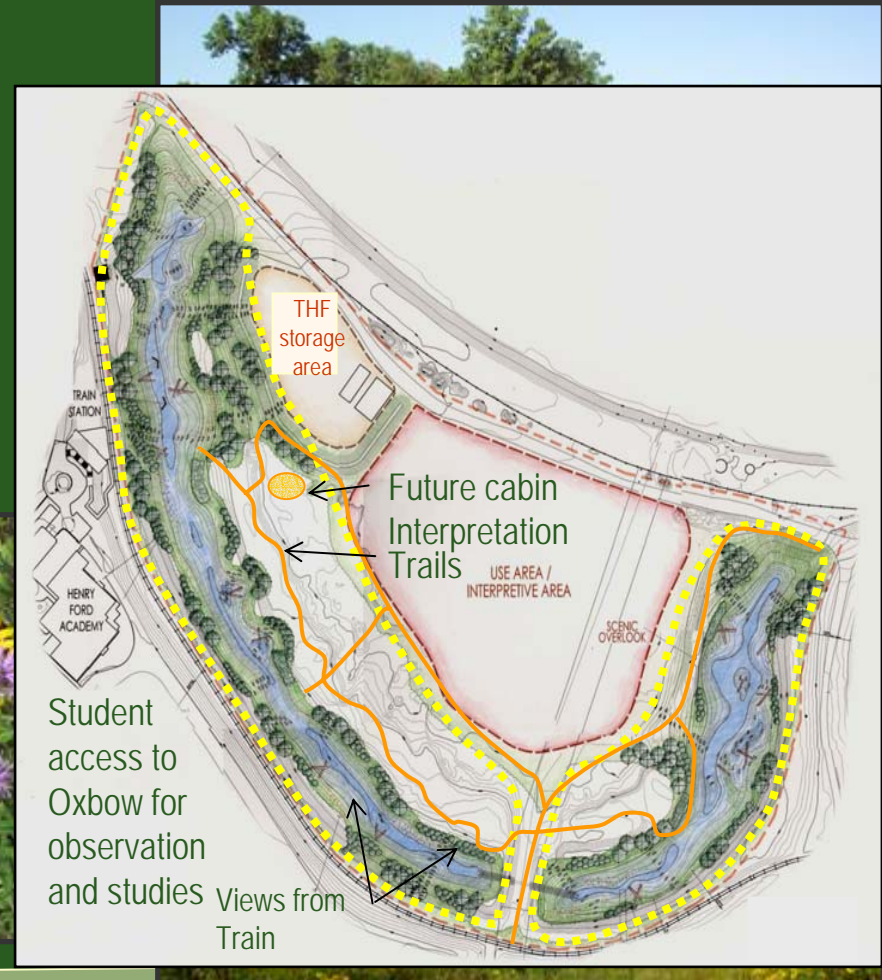

Oxbow Successes

- Prior to fish stocking, 14 species of fish were identified in the Oxbow
- Increased flood storage for the Rouge River
- Diverse wildlife sightings throughout the area, including coyote, fox, raccoon, deer, raptors, owls, bats, ducks, herons, turtle, frogs, etc.
- Potential use by Academy students with *Rouge Education Project* water quality monitoring.
- Visitor amenity to The Henry Ford, increasing their programming diversity

Numerous species are not always visible to visitors, but their tracks let us know they use the Oxbow.



Hawk nest in cottonwood tree



Rouge Oxbow Restoration – Phase 1

"The time of the falling leaves has come again. Once more in our morning walk we tread upon carpets of gold and crimson, of brown and bronze, woven by the winds or the rains out of these delicate textures while we slept."

--John Burroughs

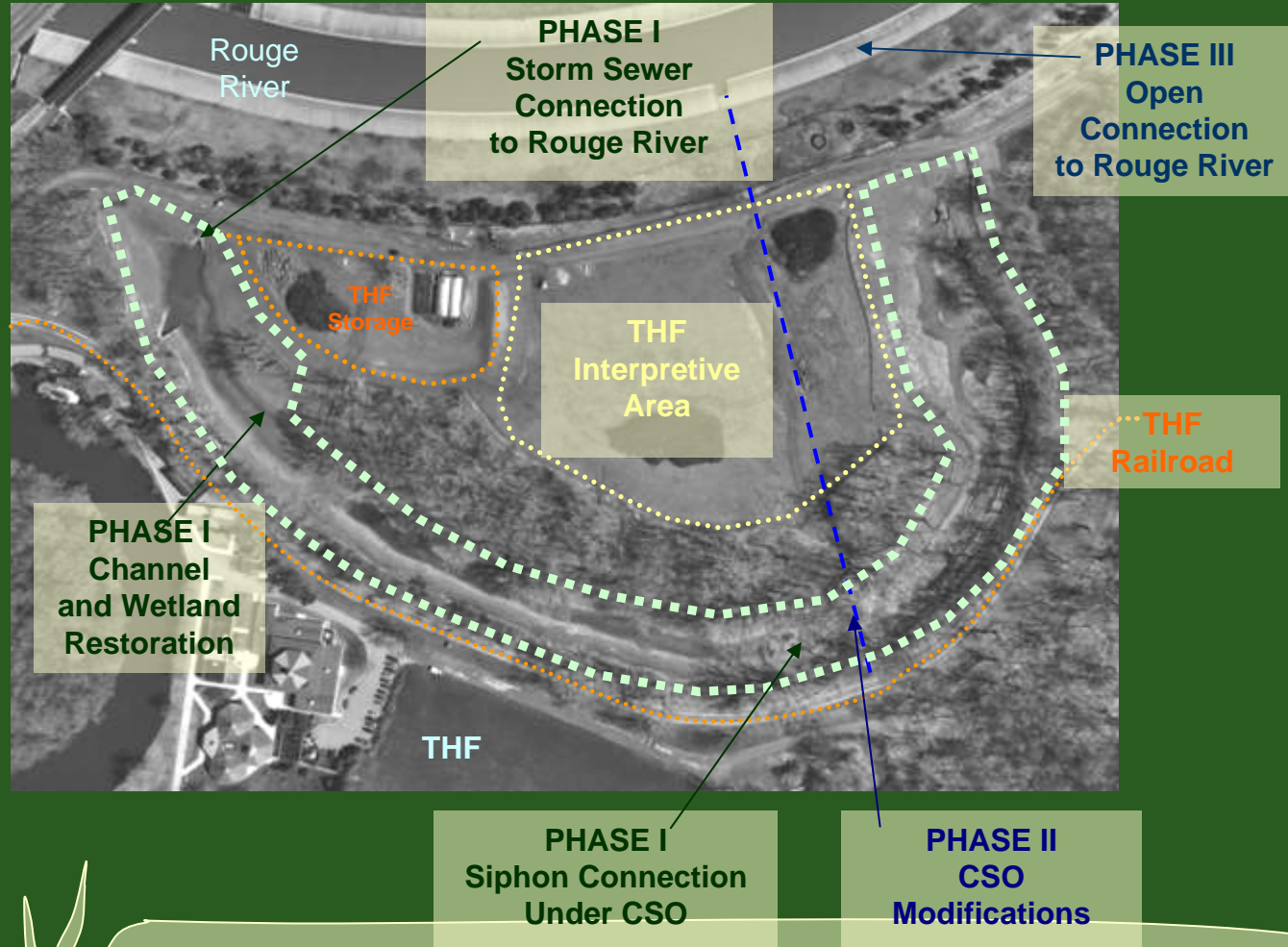

*Photo Credits: All photos by ECT, Tilton & Associates, Inc. and Air Land Survey
Graphics by: Tilton & Associates, Inc.*



Thanks to our Partners



Design/Construction Team:

Environmental Consulting & Technology, Inc.; Tilton & Associates, Inc.; Applied Science, Inc.; Hansen Engineering; Angelo Iafrate Construction and Marine City Nursery